

GENERAL DESCRIPTION

Door, frame and accessories with 30 min fire resistance and acoustic insulation rating up to 42dB.

Product suitable for installation in places with fire resistance and acoustic insulation requirements.

ACCREDITATION

Fire certification as per EN 1634-1.

EI30 rating as per EN 13501-2.

Acoustic insulation test as per ISO 10140 and rating as per ISO 717-1.

DOOR

Perimeter structure in wood rails and stiles, multi-layered interior, with characteristics as per EN 13986.

MDF facing, features as per standard EN 13986.

Lippings in dense wood, wood veneer, finish foil or painted to match the facing.

Thickness: 57 mm with rebate.

Available in models from the Essential and Exclusive ranges.

FRAME

Dense plywood or hardwood jamb, features according to EN 13986.

Adjustable plywood architrave, features according to EN 13986.

Intumescent seals and strips with specifications according to performed test.

FINISHES

Naturdor® - Real wood veneer, Stained real wood veneer or SL (Straight line veneer).

Dekordor® - 3D (Embossed laminate) HD (Heavy Duty, continuous pressure laminate) or SD (Standard Duty, finish foil)

Laccdor - Satin white or white lacquered

IRONMONGERY & OTHERS

Stainless steel CE marked YSE lock for emergency exits.

Stainless steel CE marked YDI lock with interior unlocking.

4" stainless steel CE marked hinges.

Automatic drop seal for 42dB acoustic insulation.

OPTIONS

Recessing for electronic lock.

Invisible door closer or with scissor arm.

Invisible hinges.

Eye viewer.

Anti panic bar.

Double leaf, available with 41dB acoustic insulation.

Anti smoke seal.



FIRE

EI30



ACOUSTIC



DOOR

RW43dB



DROP SEAL

RW42dB



ANTI SMOKE SEAL

ANTI SMOKE



The mark of responsible forestry



MOBILITY

Notes: As we are constantly improving our product range, we reserve the right to make changes without prior notice.

VERTICAL CUT

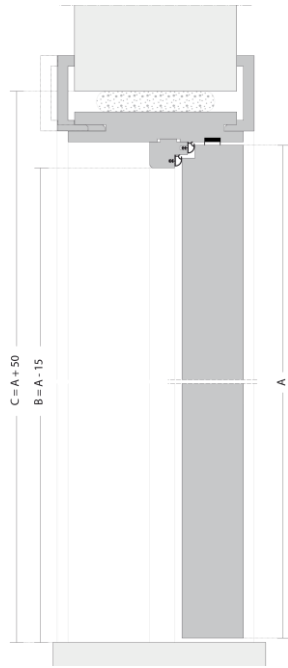

HORIZONTAL CUT

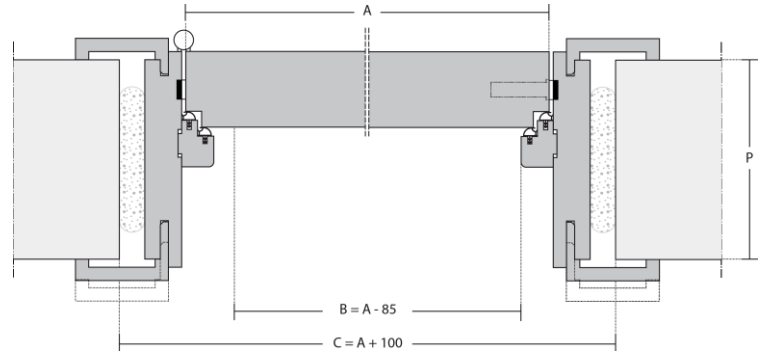

KEY

- A – Door width / height
- B – Effective clear width / height
- C – Structural opening
- P – Frame total width / height

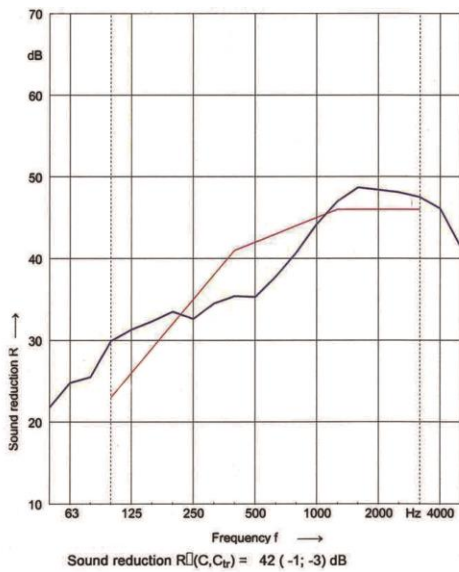

IRONMONGERY AND OPTIONS

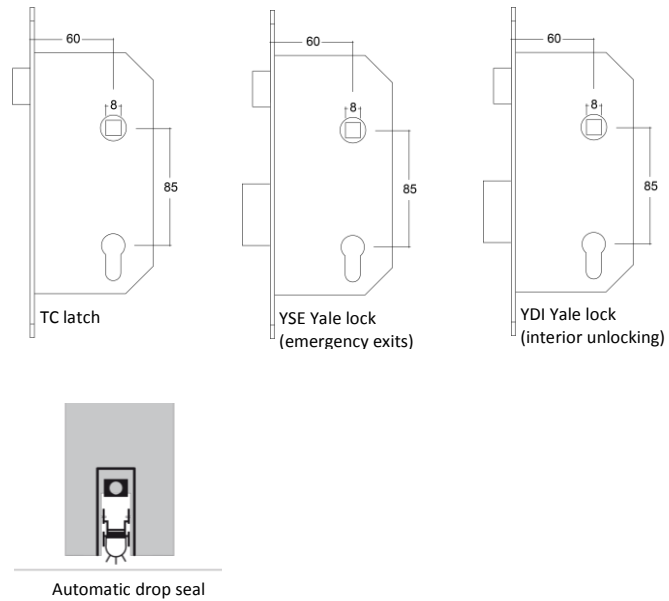

CONFIGURATIONS

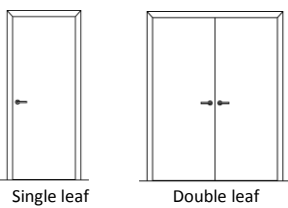

Notes: As we are constantly improving our product range, we reserve the right to make changes without prior notice.