

GENERAL DESCRIPTION

Multi-performance internal front entrance door system
Door, frame and ironmongery with security class resistance RC2, resistant to fire 45 minutes and with 45dB acoustic isolation

ACCREDITATION

RC2 security certification as per EN1627
Fire certification for EI45 as per EN13501-2
Acoustic certification for 45dB as per ISO717-1
Thermal transmission coefficient of UD: 1,17 W/(m2.°C) according to ISO 10077-1; ISO 10077-2 and ISO 10211

DOOR

Rails and stiles in softwood.
Multi-layered core
MDF facing, features as per standard EN 13986.
Lippings in solid wood or edge banded according to door face.
54mm thick with rebate.
Available in various models of Essential, Exclusive or Classic ranges.

FRAME

Jamb in solid wood, extension in plywood.
Fixed and adjustable architraves in plywood according to EN 13986 standard.
Intumescent seals with specifications according to performed test.
Intumescent and acoustic seals

FINISHES

Naturdor® - real wood veneer or stained.
Dekordor® 3D - embossed finish design.
Dekordor® HD - hard wearing laminate.
Dekordor® SD — decorative foil.
Laccdor - Lacquered finish with approximate RAL colour.

IRONMONGERY & OTHERS

Security lock with 3 point locking system - EN 15685 Standard.
Security CE marked hinges with 4" – EN 1935 Standard.
Threshold and automatic drop seal

OPTIONS

Threshold or double automatic drop seal for 44dB isolation
Concealed door closer or with scissor arm – EN 1154 Standard.
Eye viewer
Smoke seals



SECURITY

**SECURITY
RC2**



FIRE

EI45



ACOUSTIC



DOOR

RW48dB



THRESHOLD
AND DROP SEAL

RW45dB



THRESHOLD

RW44dB



DOUBLE
DROP SEAL

RW44dB



Thermal
transmission

1,17W/M².°C



ANTI SMOKE SEAL

ANTI SMOKE

VERTICAL CUT

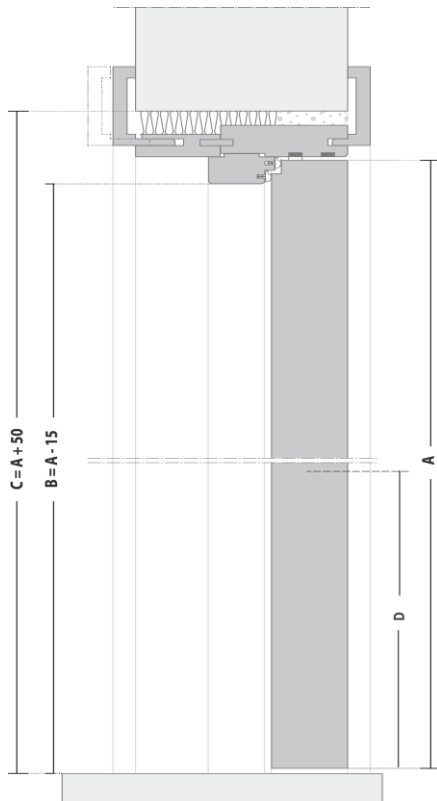

HORIZONTAL CUT

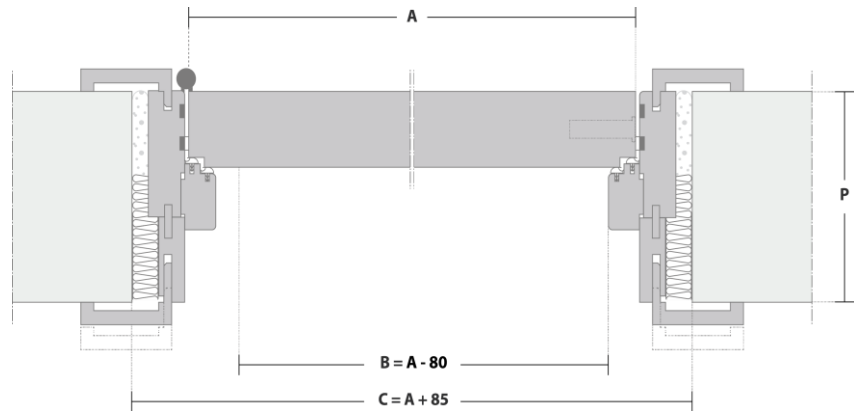

KEY

- A** – Door width / height
- B** – Effective clear width / height
- C** – Structural opening
- D** - Handle height
- P** – Frame total width / height

D - HANDLE HEIGHT (mm)	DOOR THICKNESS (mm)	P - WALL THICKNESS / FRAME ADJUSTMENT (mm)
1000	57	≥ 100
1050		[- 5 + 10]

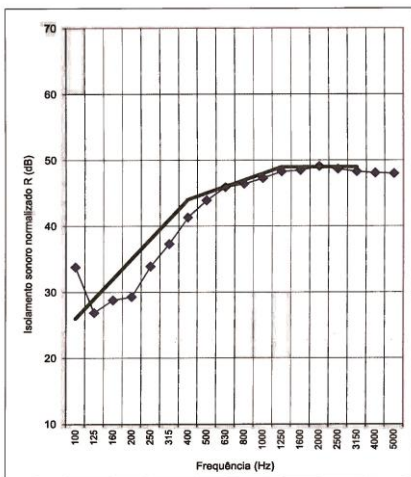

R_w (C; C₁₂₅; C₁₂₅₋₂₀₀₀; C₁₂₅₋₂₀₀₀) = 45 (-2; -6; -1; -6) dB
(Resultados obtidos de acordo com a norma NP EN ISO 717-1:2009)

ACCESORIOS Y OPCIONES

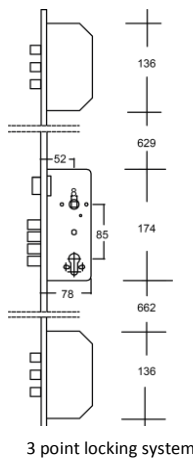

3 point locking system

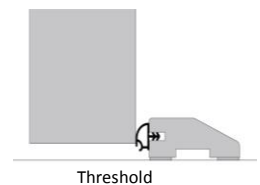

Threshold

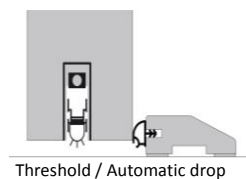

Threshold / Automatic drop

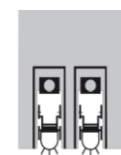

Double automatic drop seal

CONFIGURATIONS



Single leaf

Notes: Depending on product features or configurations, dimensions will vary. As we are constantly improving our product range, we reserve the right to make changes without prior notice.