









<p>GENERAL DESCRIPTION</p>	<p>Rebated door, frame and accessories with 30 min fire resistance and acoustic insulation rating up to 35dB</p>	 <p>EI30</p> <p>FIRE</p>
<p>ACCREDITATION</p>	<p>Fire certification as per EN 1634-1 EI30 rating as per EN 13501-2 Acoustic insulation test as per ISO 10140 and ISO 717</p>	 <p>ACOUSTIC</p>
<p>DOOR</p>	<p>Rails and stiles in softwood, edge banded vertical and top of the door Solid core in high density particle board MDF facing, features as per standard EN 13986 Fire and acoustic seals 10x4mm 47mm thick with rebated</p>	 <p>RW36dB</p> <p>DOOR</p>
<p>FRAME</p>	<p>In high density plywood or MR MDF, 28mm thick For thicknesses over 140mm, add extension Fixed architrave with 100mm Fire seals 15x4 mm Compression seal</p>	 <p>RW35dB</p> <p>DROP SEAL</p>
<p>FINISHES</p>	<p>Naturdor® - real wood veneer or stained Dekordor® 3D - embossed finish, vertical and horizontal design Dekordor® HD - hard wearing laminate Dekordor® SD - decorative foil Lacdor - Lacquered finish with approximate RAL colour</p>	 <p>ANTI SMOKE</p> <p>ANTI SMOKE SEAL</p>
<p>IRONMONGERY</p>	<p>Stainless steel CE marked look 3" stainless steel CE marking hinges Double automatic drop seal</p>	
<p>OPTIONS</p>	<p>Door closer face mounted, TS68 and DC135 or other suitable for product functionality, for frames up to 140mm thick Recessing for electronic lock Fire smoke seal Eye viewer</p>	
<p>ENVIRONMENTAL BENEFITS</p>	<p>Recycled content, all series FSC Certified wood, upon request</p>	<p>ACREDITATION</p>   

Note: Depending on product features or configurations, dimensions will vary. As we are constantly improving our product range, we reserve the right to make changes without prior notice. The guarantee certificate is an integral part of the technical data sheet, available at www.vicaima.com

VERTICAL CUT

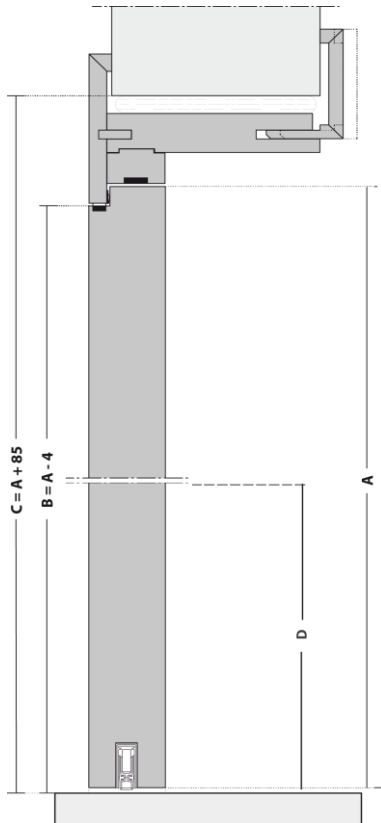

HORIZONTAL CUT

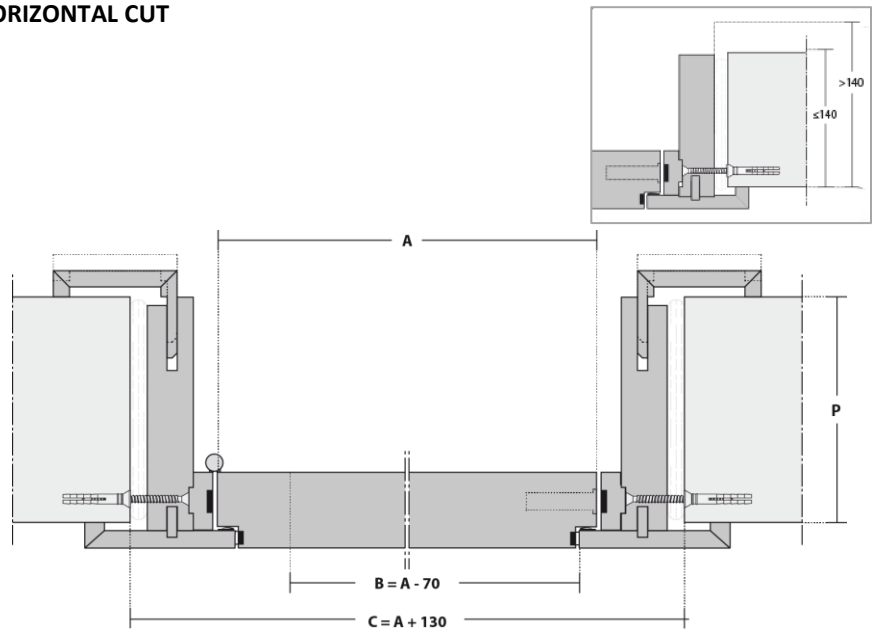

KEY

- A - Door width / height
- B - Effective clear width / height
- C - Structural opening
- D - Handle height
- P - Wall thickness

D - HANDLE HEIGHT (mm)	DOOR THICKNESS (mm)	P - WALL THICKNESS / FRAME ADJUSTMENT (mm)	
		> 80 < 100	≥ 100
1000	47	[-0+10]	[-0+15]
1050			

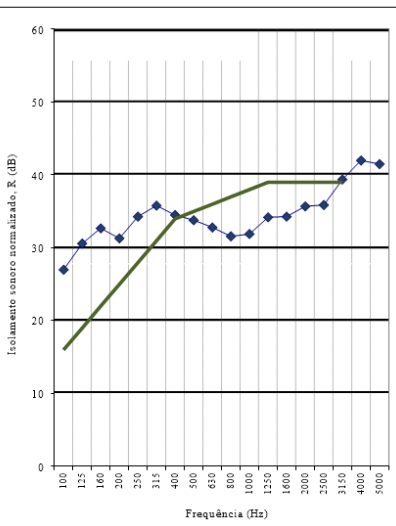

$R_w (C; C_{20}; C_{500}) = 35 (-1; -2; 0; -2) \text{ dB}$

IRONMONGERY

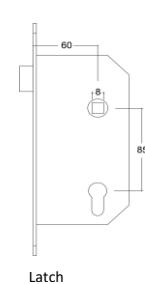

Latch

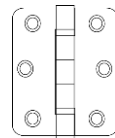

Ball bearing hinges

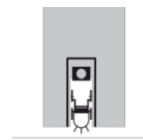

Drop seal

OPTIONS

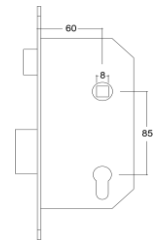

- Yale lock
- YSE-emergency exits
- YDI-interior unlocking

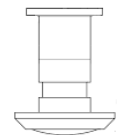

Eye viewer



Recessing for electronic lock.

CONFIGURATIONS



Single leaf

Note: Depending on product features or configurations, dimensions will vary. As we are constantly improving our product range, we reserve the right to make changes without prior notice. The guarantee certificate is an integral part of the technical data sheet, available at www.vicaima.com