

GENERAL DESCRIPTION

Door, frame and accessories, 30 min fire resistance and acoustic insulation rating up to 42dB.

Suitable for installation in places with fire resistance and acoustic insulation requirements.

ACCREDITATION

Fire certification as per BS 476 Part 22.

FD30 rating as per BS 476 Part 22.

Acoustic insulation test as per ISO 140-3 and rating as per ISO 717-1.

Thermal transmission coefficient according to ISO 10077-1; ISO 10077-2 and ISO 10211.

DOOR

Rails and stiles in softwood.

Multi-layered acoustic core.

MDF facing, features as per standard EN 13986.

Lippings in softwood vertical edge banded.

57mm thickness with rebated.

Available in models from the Essential, Exclusive and Classic ranges.

FRAME

Jamb in solid wood, extension in high density plywood.

Fixed and adjustable architrave in plywood or MDF, features according to EN 13986.

Intumescent seals with specifications according to performed test.

Isolation profile

FINISHES

Naturdor® - real wood veneer or stained.

Dekordor® 3D - embossed finish design.

Dekordor® HD - hard wearing laminate.

Dekordor® SD - decorative foil.

Laccdor - Lacquered finish with approximate RAL colour.

IRONMONGERY & OTHERS

Stainless steel CE marked

4" stainless steel CE marked hinges.

Automatic drop deal.

OPTIONS

Recessing for electronic lock.

Stainless steel CE marked YSE lock for emergency exits.

Stainless steel CE marked YDI lock with interior unlocking.

Invisible door closer or with scissor arm.

Invisible hinges.

Eye viewer.



FIRE

EI30



ACOUSTIC



DOOR

RW43dB



DROP SEAL

RW42dB



THERMAL
TRANSMISSION

1,29W/M².°C



ANTI SMOKE SEAL

ANTI SMOKE



TECHNOLOGY
CENTRE



The mark of
responsible forestry



MOBILITY

Notes: Depending on product features or configurations, dimensions will vary. As we are constantly improving our product range, we reserve the right to make changes without prior notice. The guarantee certificate is an integral part of the technical data sheet, available at www.vicaima.com.

VERTICAL CUT

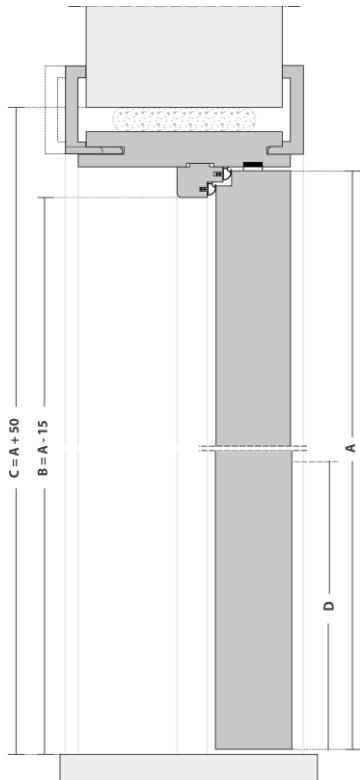

HORIZONTAL CUT

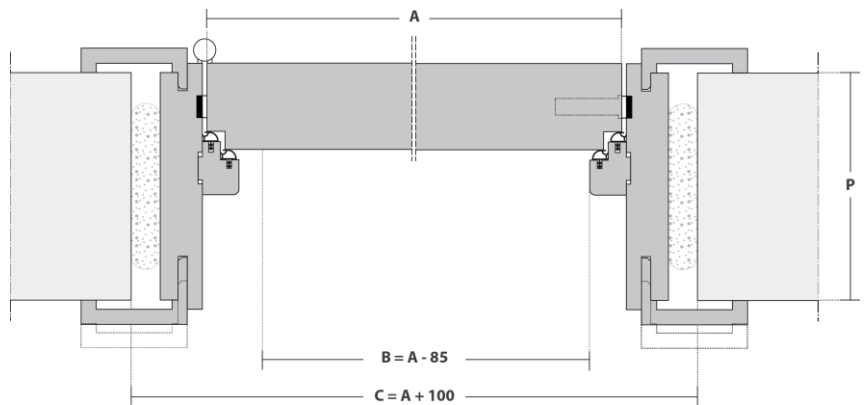

KEY

- A** – Door width / height
- B** – Effective clear width / height
- C** – Structural opening
- D** – Handle height
- P** – Frame total width / height

D - HANDLE HEIGHT (mm)	DOOR THICKNESS (mm)	P - WALL THICKNESS / FRAME ADJUSTMENT (mm)
		≥ 90
1000	57	[- 5 + 10]
1050		

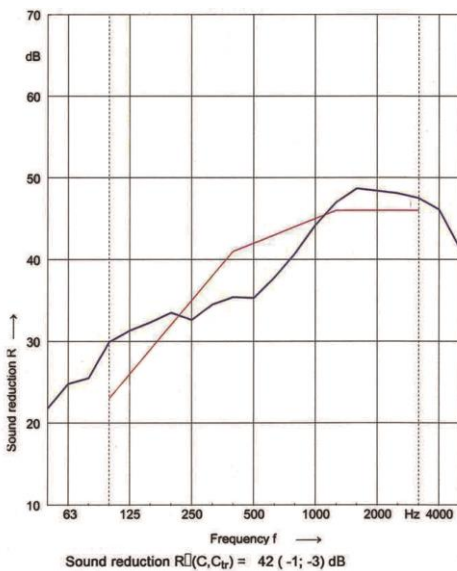

IRONMONGERY AND OPTIONS

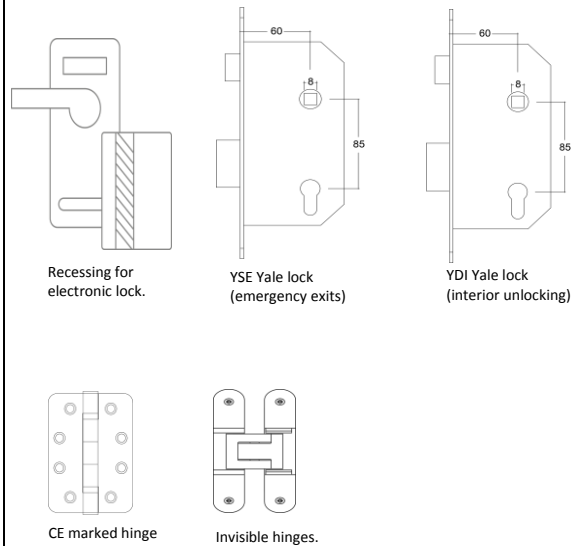

CONFIGURATIONS



Notes: Depending on product features or configurations, dimensions will vary. As we are constantly improving our product range, we reserve the right to make changes without prior notice. The guarantee certificate is an integral part of the technical data sheet, available at www.vicaima.com.