

PORTARO® FD60 AC34

HSP HIGH DENSITY CORE

TECHNICAL SHEET

vicaima
UNEXPECTED HARMONY

GENERAL DESCRIPTION

Door, frame and accessories with 60 min fire resistance and acoustic insulation rating up to 34dB

Glazing options

Product suitable for installation in places with fire resistance and acoustic insulation requirements

ACCREDITATION

Fire certification as per BS 476 Part 22

Acoustic insulation test as per ISO 10140 and rating as per ISO 717-1

Thermal transmission coefficient $U_D=1,8W/(m^2 \cdot ^\circ C)$ as per ISO 10077-1 and ISO 10077-2

DOOR

HSP high density chipboard

Lippings in hardwood vertical edge banded

54mm thick

Available in models from the Essential and Exclusive ranges

FRAME

Jamb in MR MDF, features according to EN 13986

Fixed and adjustable architrave in MR MDF, features according to EN 13986

Intumescent seals and strips with specifications according to performed test

Isolation profile

FINISHES

Naturdor® - real wood veneer or stained

Dekordor® 3D - embossed finish design

Dekordor® HD - hard wearing laminate

Dekordor® SD — decorative foil

Lacdor - Lacquered finish with approximate RAL colour

IRONMONGERY & OTHERS

Stainless steel CE marked lock

4" stainless steel CE marked hinges

Threshold or automatic drop seal for 34dB acoustic insulation

OPTIONS

Glazing option for 33dB acoustic insulation

Double leaf option for 33dB acoustic insulation

Recessing for electronic lock

Face mounted or concealed door closer

Concealed hinges (jamb in solid wood)

Eye viewer

Anti panic bar

Anti smoke seal



FIRE

FD60



ACOUSTIC



THRESHOLD

RW34dB



DROP SEAL

RW34dB



THERMAL
TRANSMISSION

1,8 W/m² K

OPTIONAL



ANTI SMOKE SEAL

ANTI SMOKE



The mark of
responsible forestry



MOBILITY

Notes: Depending on product features or configurations, dimensions will vary. As we are constantly improving our product range, we reserve the right to make changes without prior notice. The guarantee certificate is an integral part of the technical data sheet, available at www.vicaima.com.

PORTARO® FD60 AC34

HSP HIGH DENSITY CORE

TECHNICAL SHEET

VERTICAL CUT

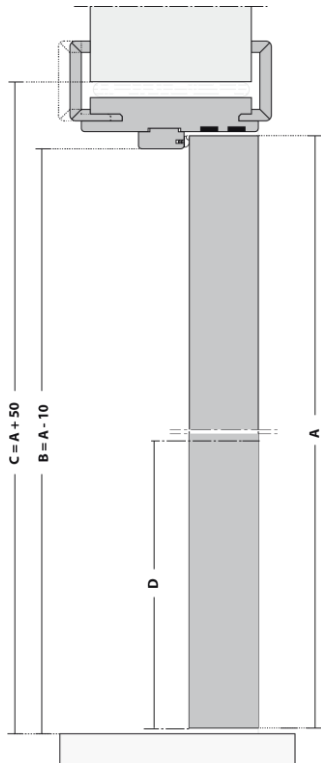

HORIZONTAL CUT

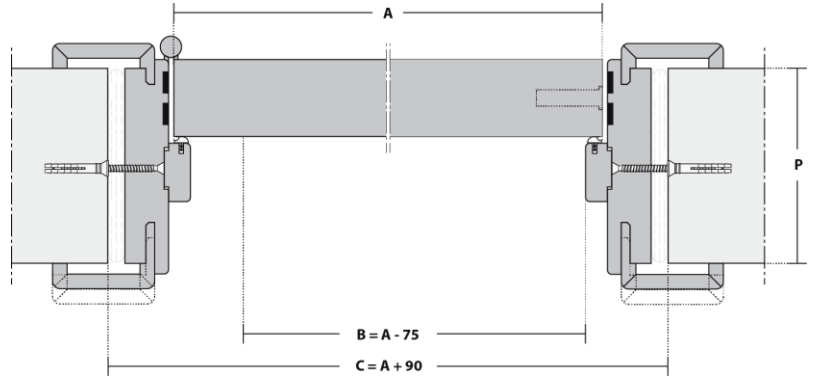

KEY

- A – Door width / height
- B – Effective clear width / height
- C – Structural opening
- D - Handle height
- P – Frame total width / height

D - HANDLE HEIGHT (mm)	DOOR THICKNESS (mm)	P - WALL THICKNESS / FRAME ADJUSTMENT (mm)
1000	54	≥ 100
1050		[- 5 + 10]

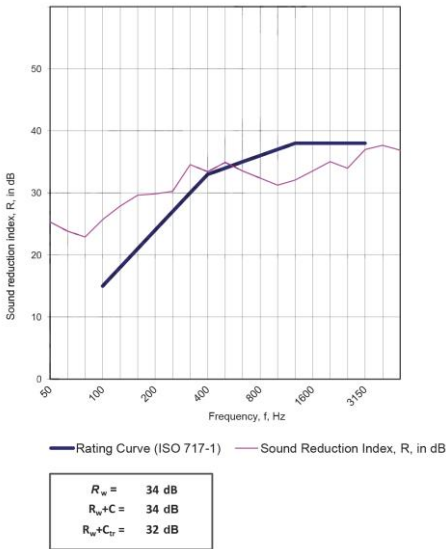

IRONMONGERY AND OPTIONS

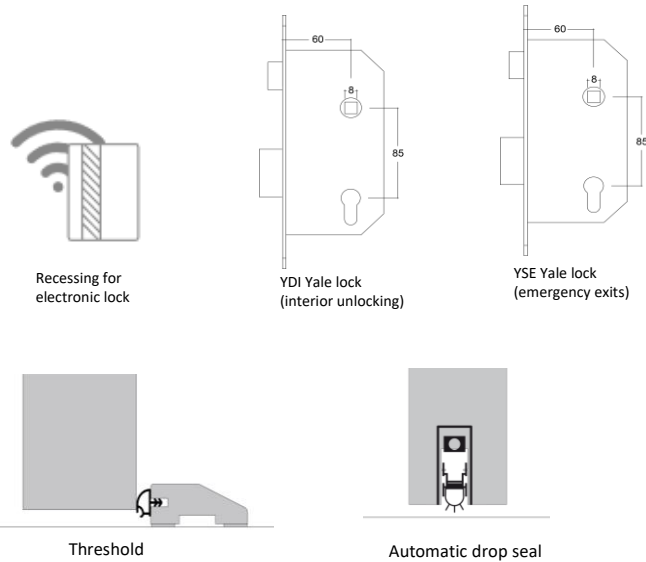

CONFIGURATIONS

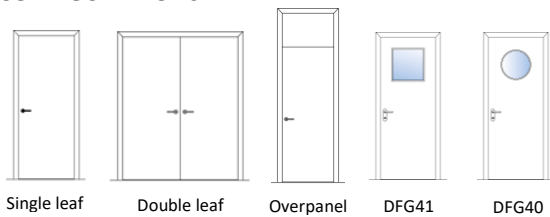

Notes: Depending on product features or configurations, dimensions will vary. As we are constantly improving our product range, we reserve the right to make changes without prior notice. The guarantee certificate is an integral part of the technical data sheet, available at www.vicaima.com.